

Wall Cabinet Manual

GUIDE D'UTILISATION DE L'ARMOIRE MURALE

Instruction pour le changement des piles

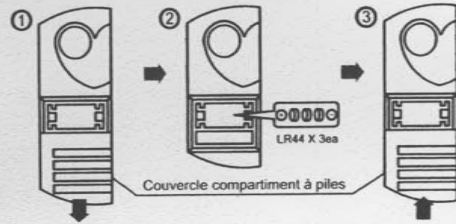

- ① Ouvrir le compartiment à piles
- ② Insérer les 3 piles LR44 comme indiqué sur la photo
Assurez-vous que le sens de polarité des piles soit respecté
- ③ Fermer le compartiment à piles
△ Attention : Changer les 3 piles en même temps.
Ne pas insérer des piles usagées avec des neuves.

- Les piles de l'alarme ont une autonomie de 30 minutes en utilisation continue (si la porte de l'armoire reste ouverte)
- Alimentation par 3 piles bouton type LR44 X 3EA
- Pour mettre l'alarme en service, baisser le bouton sur le boîtier de l'alarme puis fermer la porte.

CU Medical Systems, Inc. www.cu911.com

• Head office

Dongwha Medical Instrument Complex
1647-1 Dongwha-ri, Munmak-eup, Wonju-si,
Gangwon-do, 220-801 Republic of Korea
TEL : +82 31 578 5725 / FAX : +82 31 578 5729

• Europe

Branch Office of CU Medical Systems, Inc. in Germany
Kuesler Strasse 6, 30519 Hannover, Germany
TEL : +49 511 365 4353 / FAX : +49 511 848 6054

NF-OA12 - Armoire murale pour défibrillateur

NOTICE

Battery Replacement Method

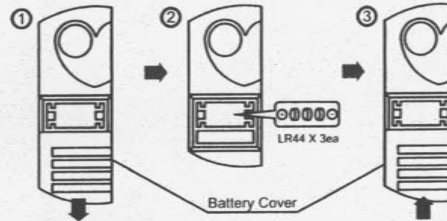

- ① Open the battery compartment cover.
- ② Insert the LR44 battery as shown in the picture.
Ensure that the batteries are inserted with correct polarity.
- ③ Close the battery compartment cover.
△ CAUTION : Do not use new and used batteries together.

- The battery for the audible alarm lasts for about 30 minutes if the door remains open.
- Battery Type : LR44 X 3EA
- Turn on the alarm button on the low right.

CU Medical Systems, Inc. www.cu911.com

• Head office

Dongwha Medical Instrument Complex
1647-1 Dongwha-ri, Munmak-eup, Wonju-si,
Gangwon-do, 220-801 Republic of Korea
TEL : +82 31 578 5725 / FAX : +82 31 578 5729

• Europe

Branch Office of CU Medical Systems, Inc. in Germany
Kuesler Strasse 6, 30519 Hannover, Germany
TEL : +49 511 365 4353 / FAX : +49 511 848 6054

주의사항

경광등 배터리 교체방법



- ① (+) 드라이버로 경광등의 커버를 연다.
- ② AA 배터리 2개를 교체한다.
- ③ (+) 드라이버로 경광등의 커버를 닫는다.

- 보관함의 문이 열려져 있을 경우 알람 및 경광등에 사용되는 배터리의 연속 사용 시간은 30분입니다.
- 배터리 종류 : AA 배터리 X 2EA
- 경광등 및 알람은 캐비닛의 위쪽에 부착되어 있습니다.

(주)씨유메디칼시스템 www.cu911.com

• 본사 / 공장

강원도 원주시 문막읍 동화리 1647-1
동화의료기기산업단지 (220-801)
전화 : 033-747-7657
팩스 : 033-747-7659

• 의왕사무소

경기도 의왕시 정계동 991-4번지
정계프라자 5층
전화 : 031-421-9700
팩스 : 031-421-9911
A/S 문의 : 080-910-0911

French

English

Korean

CU Medical Systems, Inc.